



Labrador Series L21 / L24 / L28

Quick Guide

This guide is intended for quick consultation only and does not replace the user and maintenance manual. Before using this machine, read the user maintenance manual contained in the machine's packaging and follow all the instructions.

PREPARATION AND OPERATION

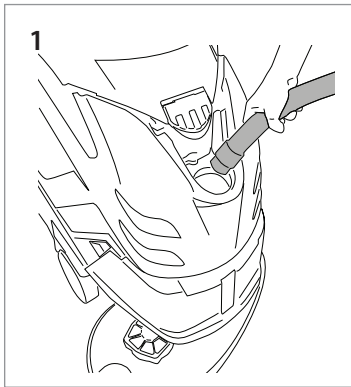

1 Add water and chemical to tank. Power on.

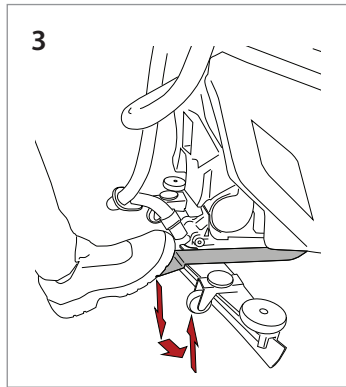
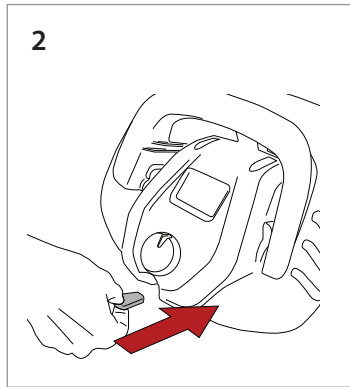

3 Press lever pedal to move the brush up and down.

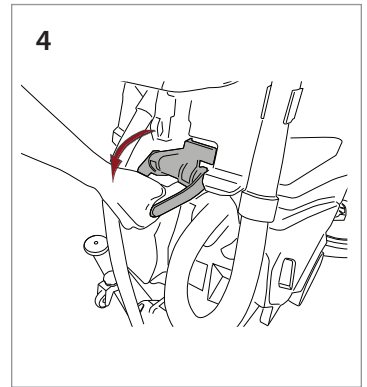

4 Pull squeegee lever.

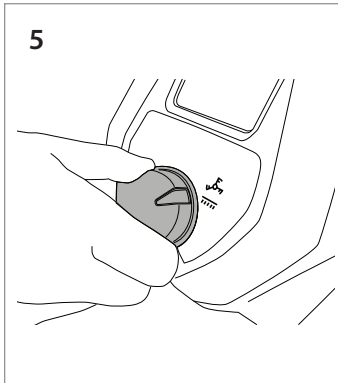

5 Auto Mode

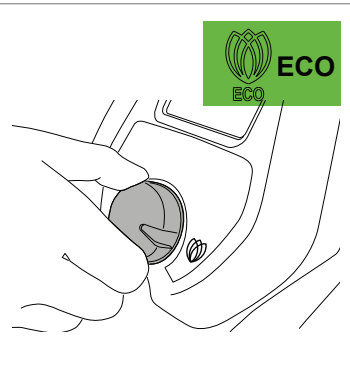

Eco Mode

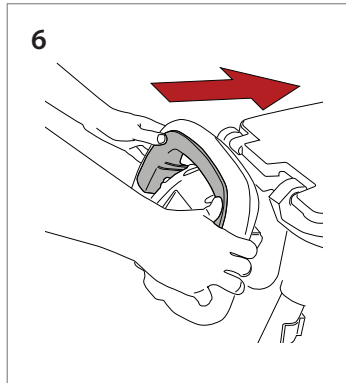

6 Go in forward direction.

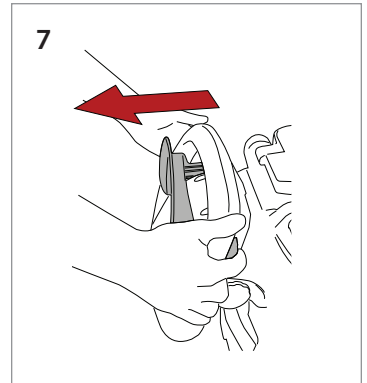

7 Go in reverse direction.

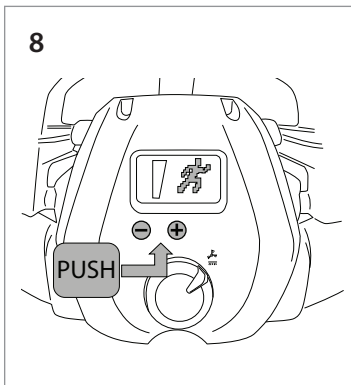

8 Adjust speed.

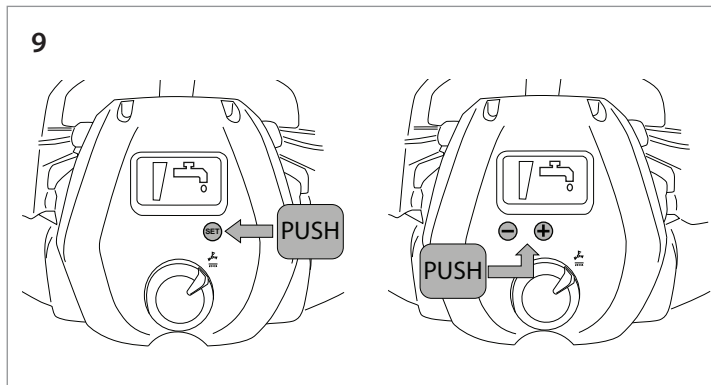

9 Adjust water level.

DAILY MAINTENANCE

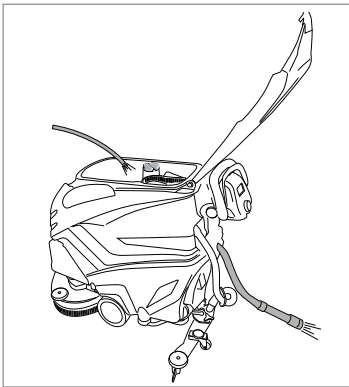

Clean the dirty water tank.

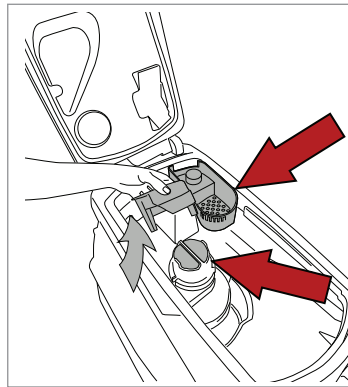

Make sure the suction filter and dirt filter are clean.

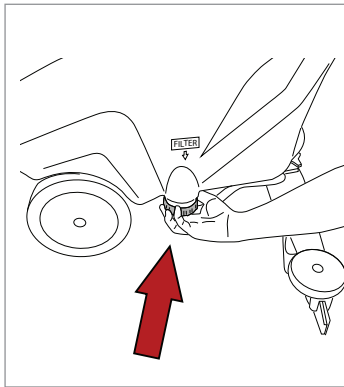

Make sure the detergent outlet filter is clean.

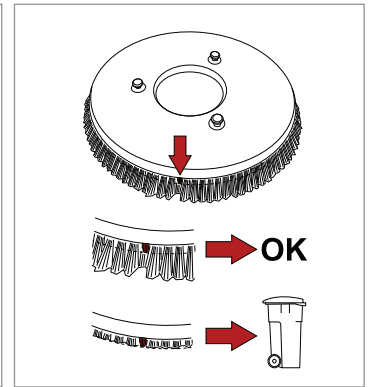

Make sure the brushes are clean. Replace if necessary.

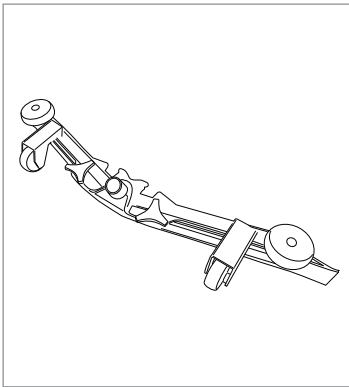

Make sure the squeegee is clean and the blades are not worn.

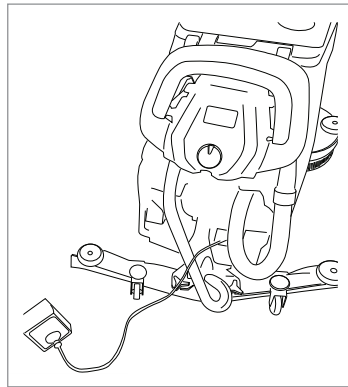

Charge the machine by plugging in the on-board charger.

REPLACING THE SQUEEGEE BLADES

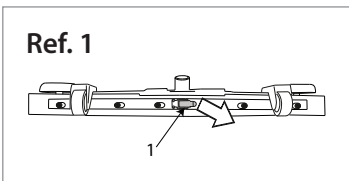

Open the clip (Ref. 1).

Remove the two blade retainers (Ref. 2) by pushing them outwards then extracting them.

Remove the blade.

Reuse the same blade by reversing the edge in contact with the floor until all four edges are worn out, or replace with a new blade, fitting it onto the screws on the body of the squeegee.

Reposition the two blade pressing devices by centering the wider part of the slots on the squeegee body fastening pins, then push the blade pressing devices inwards.

Close the hook again.

Replace the squeegee on its support, following the instructions previously described.

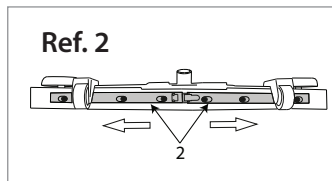

ATTACHING/REMOVING THE BRUSHES

Ref. 1

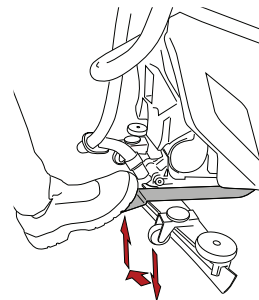

Ref. 2

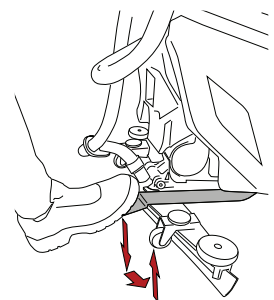

Attaching:

Raise the machine head by pushing the head lift pedal (Ref. 1) down and to the left, then using the operation selector, select the Brush control, rest the brush on the floor in front of the machine and centre it with the head. Lower the head by pushing the head lift pedal (Ref. 2) down and to the right and activate the drive lever momentarily; the brush will be attached automatically to the hub on the flange. If the operation is not successful, repeat by pressing the lever again and repeating the centring procedure. Use of abrasive/microfibre disks: fit the abrasive/microfibre disk on the drive disk and perform the operations described for fitting the brush on the scrubber drier.

Releasing:

Raise the machine head by pushing the head lift pedal (Ref. 1) down and to the left, turn the selector to the "OFF" position, press the "SET" button once then press the "-" button, the machine will complete the release sequence.